

# SQ Blaster Quick Start Guide

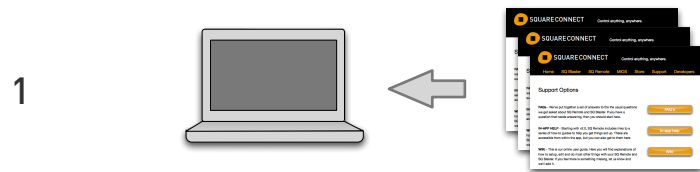

Download and install the USB drivers and setup wizard software for Mac or PC from the Square Connect website: [www.squareconnect.com/wizard.html](http://www.squareconnect.com/wizard.html)



Install the USB drivers, then plug in the blaster unit and finally start the wizard program and follow the on screen instructions. You will need the name (SSID) of your home Wi-Fi network as well as the password/pass-phrase.

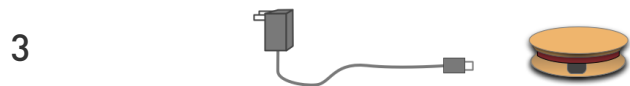

After completing the wizard setup and setting the blaster network settings to your home Wi-Fi network, unplug the blaster from your PC/Mac and connect your blaster to a continuous power source – either with the USB cable to a powered USB socket, or with a 5V, 500mAh USB power supply.



Install SQ Remote Lite, the free companion application for your iPhone / iPod touch / iPad. In the Apple App Store search for “SQ Remote”. All further configuration is done with the SQ Remote app.

You may also decide to upgrade to SQ Remote HD for a small charge. SQ Remote HD is a universal iOS app that uses the full screen of the iPad.

When you have completed the steps above, please follow the “Setup Guide for SQ Remote” to get you started with configuring SQ Remote and to begin controlling your home entertainment equipment with your SQ Blaster.